

Tower and Lower Unit

The tower is a durable aluminum casting with an integral water pump and enclosed exhaust housing. The top surface is machined and ready to be drilled for your engine’s bolt pattern. A heavy-duty one-inch diameter swivel pin is provided.

The lower unit is manufactured from a high strength aluminum casting with a smooth brush aluminum finish. Has 11/16 inch propeller shaft with a 1/4 inch shear pin hole and a 12mm square coupling pinion shaft. The water pickup is low on the unit in front of the skag leading edge. Unit mounts with a standard four bolt Konig® bolt pattern.

Lower unit gear ratios include 17:17, 16:17 or 17:16 overdrive. Gears are manufactured from alloy steel, are carbonized, hardened, and spline mounted to high strength shafts.

Assembly and disassembly of this lower unit requires no special tools or jigs. The shafts, bearings and gears are all assembled onto a bearing block that is inserted into the housing and held in place by a locking bar and bolt. The unit is o-ring sealed against water intrusion.

Minimum Finish Dimensions (inches)

| Q | T | U | V |
|------|-----|-----|-----|
| 11.7 | 5.0 | 3.0 | 4.0 |

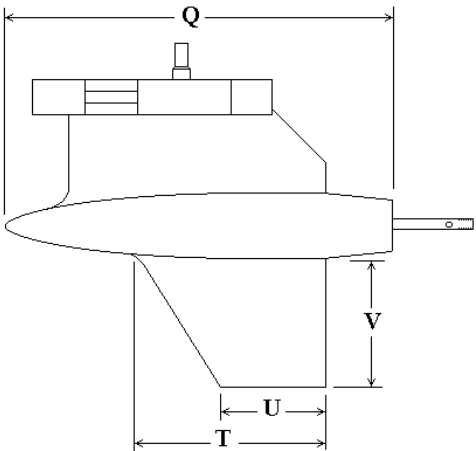

| W | S | R |
|-----|-----|-----|
| 4.4 | 2.0 | 2.0 |

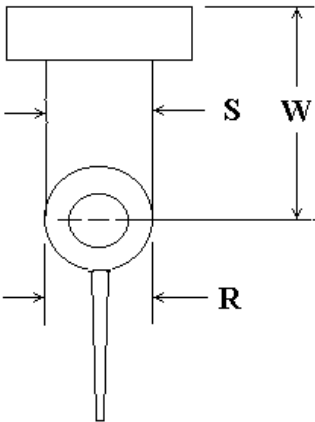

Approximate Finish Dimensions (inches)

| H | D | W | L |
|-----|---|-----|-----|
| 8.5 | 1 | 6.5 | 8.5 |

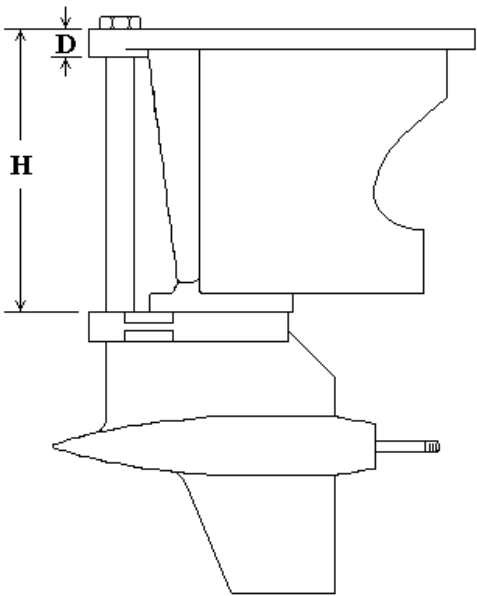
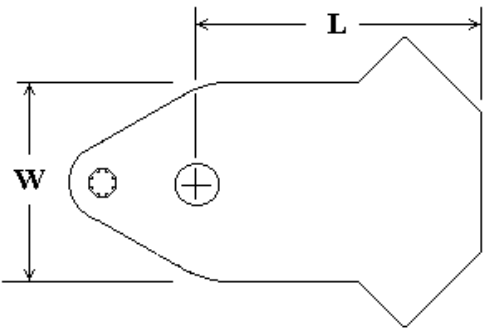

Products

Tohatsu M50D2 Racing
Lower Unit
Tower Housing
12mm Coupling
Bolt-on Transom Mount

Information Assistance Order

Contact: Sid Bass

2622 Rocky Point Rd
Bremerton, WA 98312
Shop (360) 373-3839
Evenings (360) 830-2486

100U

Bass

Machines

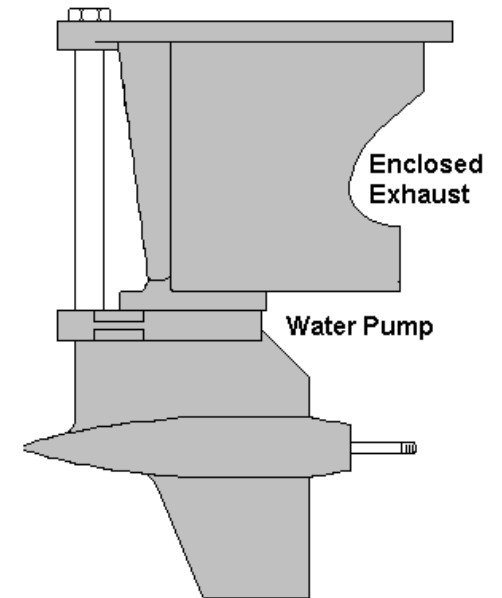

Tower &

Lower Unit